

4 DRAIN HOLES R12 90° DISPLACED

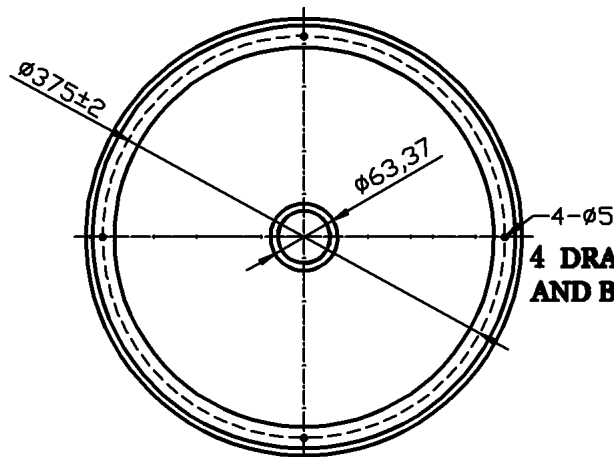

4 DRAIN HOLES TOP AND BOTTOM SKIRT

**CAPACITY: 50+0.1~0.4LTS**  
**WEIGHT: 12.8±5%KGS**  
**MATERIAL: SUS304-2B**  
**KEG PICKLED AND PASSIVATED**  
**NECK: DROP IN**  
**USAGE PRESSURE: ≤0.3MPa(45PSI)**  
**TEST PRESSURE: ≤0.6MPa(85PSI)**

Standard Kegs LLC  
 info@standardkegs.com  
 www.standardkegs.com

50L EURO			
Unit	MM	Weight	12.8±5%Kg
Proportion	1:6	Volume	50L
Material	SUS 304 / 1.4301		